

Bumper Kit (300180)

This dock bumper is designed to protect your boat . This bumper will attach to the EZ Dock product using embedded T-nuts.

Installation

Tools Required:

#4 Phillips Screwdriver

1. Select the set of T-nuts you want to attach the bumper to.
2. Clean out any grit or debris that might have gotten into the stainless-steel inserts in the dock.
3. Secure bumper using two flat washers (117005) and 5/16" X 1-1/2" Phillips Truss head Bolts (80515SS).

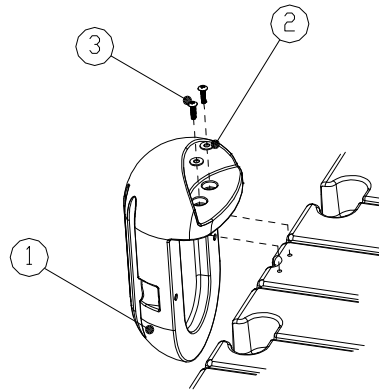

ITEM	QTY.	PART NO.	DESCRIPTION
1	1	S30180	BUMPER DOCK
2	2	117005	WASHER 3/8" FLAT SS
3	2	80515SS	BOLT 5/16"-18 X 1-1/2" TRUSS SS